

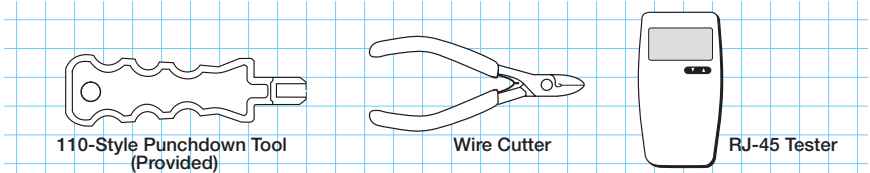

XTP DTP 24 Punch Down Jack • Setup Guide

The following tools are required to terminate the shielded XTP DTP 24 punch down connector:



Follow these instructions to terminate the connector:

- Slide the rear case of the connector over the cable. Push the case back at least 3 inches (76 mm) to make room for the termination of the cable.

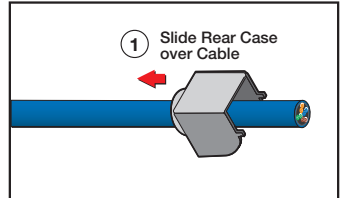

- Remove about 2 inches (50 mm) of the cable jacket.

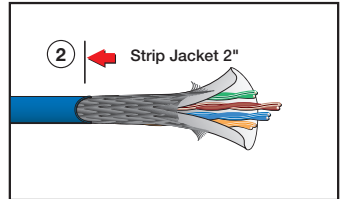

- Fold down the braid over the cable jacket. Remove the foil and mylar shielding (if present).

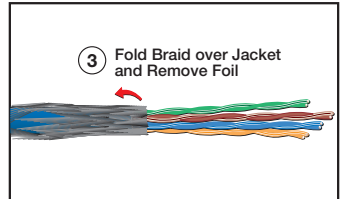

- Note the color codes and pin numbers on the sides of the connector. Follow the color code in the table at right to wire the connector.

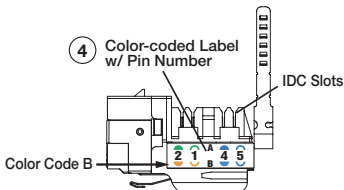

T568B Wiring	
IDC Position	T568B Wire Colors
1	White/Orange
2	Orange
3	White/Green
4	Blue
5	White/Blue
6	Green
7	White/Brown
8	Brown

- Untwist the wire pairs and hold the end of the stripped cable jacket close to the back of the connector. The length of the exposed wires in the connector should not exceed 0.6 inch (see image at right).

ATTENTION: Failure to position the cable properly may result in crosstalk and improper termination.

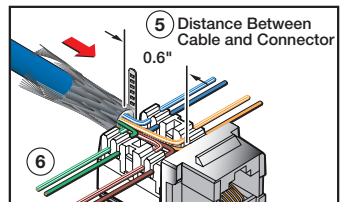

- Position each wire into its respective IDC slot. Insert the wires just far enough to hold them in the IDC slots.

7. Use the 110-style punchdown tool to push down each wire into the IDC slot. Push the punchdown tool until the wire is firmly secured at the bottom of the slot.

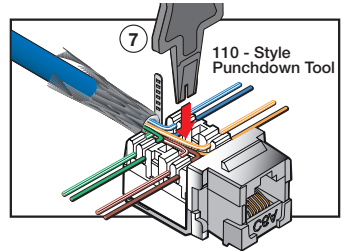

8. Trim the excess wire flush with the body of the connector.

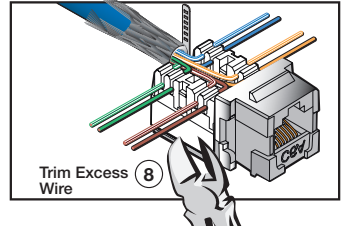

9. Tighten the grounding tie around the braid.

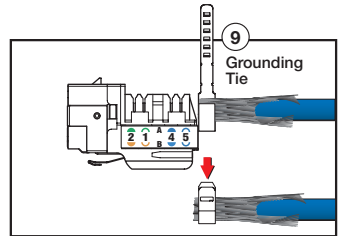

10. Remove the excess braid at the grounding tie.

11. Place the plastic cover over the termination wires for secure connection and added strain relief.

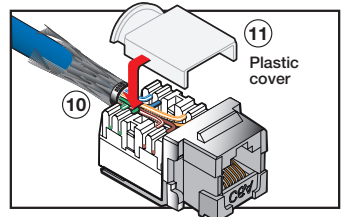

12. Push the rear case forward until it clicks into position over the terminated connector.

13. Test both ends of the cable for conductivity.

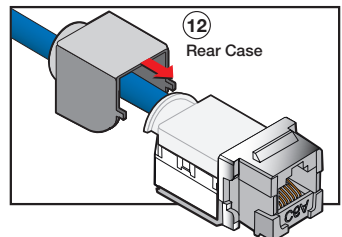

NOTE: If there is a need to re-terminate the connector, insert a tweaker on the bottom of the rear case and slide it back to access the wires.

NOTE: The wire retention mechanism in these connectors is very secure. If a terminated cable must be separated from its connector, separate it one wire at a time.

68-2370-50
Rev. C
04 13

Extron USA Headquarters
+1.800.633.9876 (Inside USA/Canada Only)

Extron USA - West: +1.714.491.1500 FAX: +1.714.491.1517
Extron USA - East: +1.919.850.1000 FAX: +1.919.850.1001