

## LockIt® HDMI Cable Lacing Bracket Installation Guide

The Extron® LockIt lacing bracket makes it possible to simply and universally secure a standard HDMI® cable to most HDMI devices.

**NOTE:** The HDMI device must have an HDMI connection mounting screw for this bracket to be used.

### To securely fasten an HDMI cable to a device:

1. Plug the HDMI cable into the panel connection.
2. Loosen the HDMI connection mounting screw from the panel enough to allow the LockIt lacing bracket to be placed over it. The screw does not have to be removed.

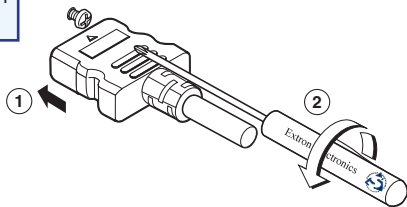

3. Place the LockIt lacing bracket on the screw and against the HDMI connector, then tighten the screw to secure the bracket.

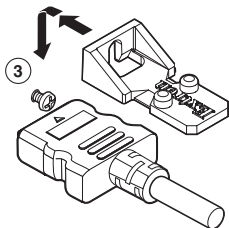

**CAUTION:** Do not overtighten the HDMI connection mounting screw. The shield it fastens to is very thin and can easily be stripped.

4. Loosely place the included tie wrap around the HDMI connector and the LockIt lacing bracket as shown.

5. While holding the connector securely against the lacing bracket, tighten the tie wrap, then remove any excess length.

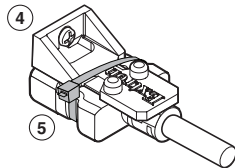

## LockIt® HDMI Cable Lacing Bracket Installation Guide, continued

The LockIt HDMI lacing bracket can be used in a number of different configurations as shown.

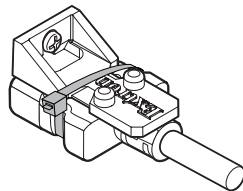

Top Mounted

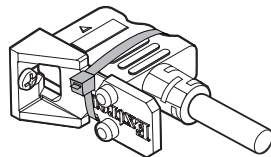

Side Mounted

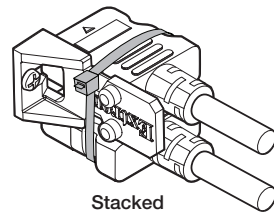

Stacked

**NOTE:** The tie wrap can also be tightened using pliers or similar tools.

**Extron Headquarters**  
+1.800.633.9876 (Inside USA/Canada Only)

**Extron Asia**  
+65.6383.4400

**Extron China**  
+86.21.3760.1568

**Extron Korea**  
+82.2.3444.1571

**Extron Europe**  
+31.33.453.4040

**Extron Japan**  
+81.3.3511.7655

**Extron Middle East**  
+971.4.2991800

**Extron India**  
+91.80.3055.3777