

Specifications

BB 710M

General

Mounting.....	In-wall mounting
Material	Steel
Enclosure dimensions	7.0" H x 8.2" W x 2.5" D 17.7 cm H x 20.7 cm W x 6.2 cm D

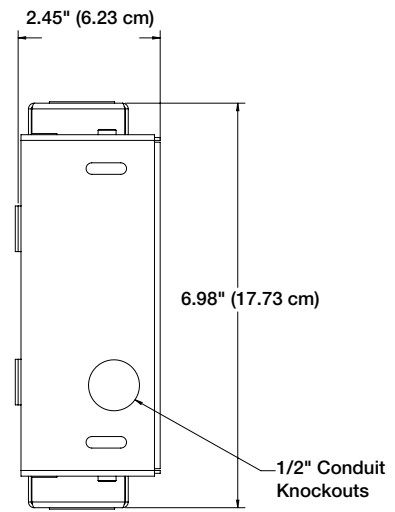
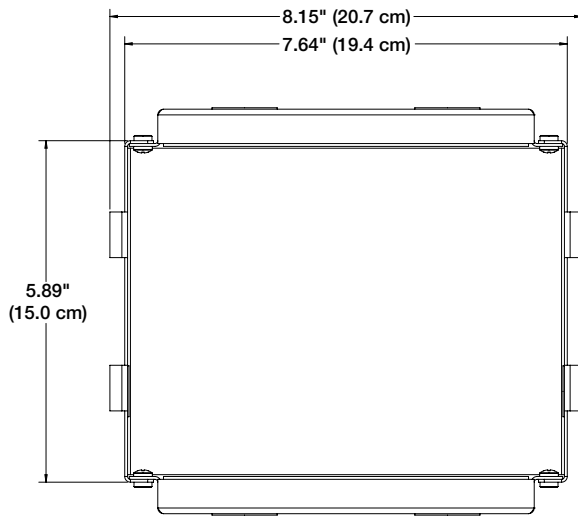
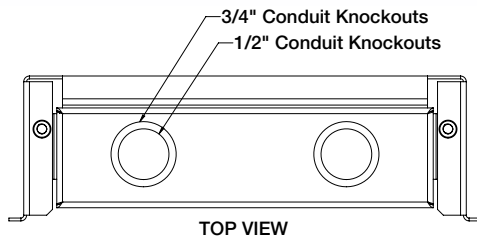

Surface cutout.....	6.0" H x 7.7" W (19.5 cm H x 15.1 cm W)
Conduit knockouts.....	8 per unit, 1/2" and 3/4" diameter
Product weight.....	1.6 lbs (0.74 kg)
Shipping weight.....	2 lbs (1 kg)
Vibration	ISTA 1A in carton (International Safe Transit Association)
Regulatory compliance	
Safety	CE, c-UL, UL
Environmental.....	Complies with the appropriate requirements of RoHS, WEEE
Warranty.....	3 years parts and labor

NOTE: Specifications are subject to change without notice.

8.0-111611-D1