

TLC Pro 521 M

5" WALL MOUNT TOUCHLINK PRO CONTROLLER



The Extron TLC Pro 521M combines a 5" wall mount touchpanel with a powerful Extron control processor. The TLC Pro 521M borrows the vibrant, capacitive touchscreen of the TLP Pro 520M TouchLink Pro Touchpanel, and adds a secure, powerful control processor, producing a feature-packed touchscreen in a compact form factor. The TLC Pro 521M is ideal for classrooms, boardrooms, or any presentation environment requiring the visual appeal of a touchpanel and the flexible control options found within Extron control processors.

- ▶ **5" capacitive touchscreen with 800x480 resolution and 16 million colors**
- ▶ **Built-in control processor:**
 - One bidirectional RS-232 port
 - Two relays for controlling room functions
 - One IR/Serial port for one-way control of external devices
 - One digital input for connection to sensors, switches, relays, and more
- ▶ **Power over Ethernet allows the controller to receive power and communications over a single Ethernet cable**
- ▶ **Supports Ethernet-controllable devices:**
 - Up to 4 devices with GC Plus
 - Up to 8 devices with GC Pro
- ▶ **Removable captive screw connectors provide quick and easy connection**
- ▶ **Light sensor adjusts screen brightness as the ambient room lighting changes**



DESCRIPTION

The **TLC Pro 521M** is a convenient, all-in-one 5" wall mount touchpanel with a built-in control processor. In addition to its convenience and ease-of-use, it features built in Ethernet control of up to four devices with GC Plus and eight devices with GC Pro. This allows simple touchpanel control of multiple Ethernet-enabled AV devices, such as displays, switchers, and sources.

The TLC Pro 521M is configured using Global Configurator Plus or Global Configurator Professional software. It also integrates seamlessly with Extron's award-winning GlobalViewer® Enterprise software for complete AV resource monitoring, management, and control over a computer network.

The TLC Pro 521M control interface can be customized using Extron GUI Designer software. This powerful interface design software offers ready-to-use templates for a wide variety of rooms and presentation environments.

KEY FEATURES

- ▶ **Built-in control processor** – Optimized for environments where component space may be a concern.
- ▶ **One bidirectional RS-232 port** – Dedicated port for communicating with virtually any device via RS-232.
- ▶ **Two relays for controlling room functions** – Enables control of lighting, screen settings, and other device functions.
- ▶ **One IR/Serial port for one-way control of external devices**

APPLICATION DIAGRAM

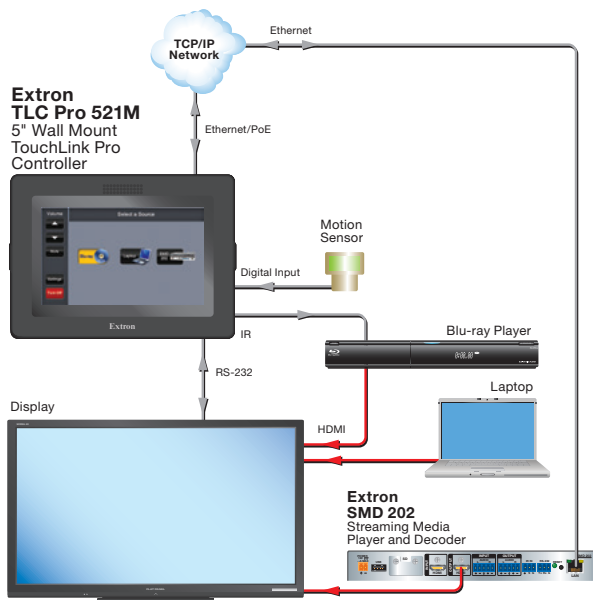

SPECIFICATIONS

| DISPLAY | | |
|---|---|--------------------|
| Screen type | Active matrix TFT color display | |
| Size | 5" (12.7 cm), measured diagonally | |
| Resolution | 800x480 | |
| Aspect ratio | Widescreen | |
| Color depth | 16 M colors | |
| Contrast | 250:1 | |
| MEMORY | | |
| SDRAM | 512 MB | |
| Flash | 512 MB | |
| COMMUNICATION – ETHERNET INTERFACE | | |
| Ethernet control/communications port | 1 female RJ-45 connector | |
| Ethernet data rate | 10/100Base-T, half/full duplex with autodetect | |
| TOUCHPANEL SENSORS | | |
| Motion sensor | On/off | |
| Light sensor | On/off | |
| DIGITAL INPUT CONTROL | | |
| Quantity/type | 1 digital input | |
| Connector | (1) 3.5 mm captive screw connector, 2 pole | |
| SERIAL CONTROL | | |
| Quantity/type | 1 bidirectional RS-232 | |
| Connector | (1) 3.5 mm captive screw connector, 3 pole | |
| RELAY CONTROL | | |
| Quantity/type | 2 normally open relays | |
| Relay control connectors | (1) 3.5 mm captive screw connector, 3 pole | |
| IR/SERIAL CONTROL | | |
| Quantity/type | 1 programmable: unidirectional RS-232 (±5 V), or TTL level (0 to 5 V) infrared (carrier or non-carrier) | |
| Connector | (1) 3.5 mm captive screw connector, 2 pole | |
| AUDIO OUTPUT | | |
| Speaker output | 1 mono, 86 dB SPL, 0.1 watt, 0.1 m, half space | |
| GENERAL | | |
| Power supply | Not included | |
| Power input requirements | 12 VDC or Power over Ethernet (PoE 802.3af, class 3) | |
| Mounting | | |
| Furniture or wall mount | With included hardware | |
| Regulatory compliance | | |
| Safety | CE, c-UL, UL | |
| EMV/EMC | CE, C-tick, FCC Class A, ICES, VCCI | |
| Environmental | Complies with the appropriate requirements of RoHS and WEEE. | |
| Warranty | | |
| 3 years parts and labor; touchpanel display and overlay components are covered for 1 year | | |
| Model | Version Description | Part number |
| TLC Pro 521M | Wall Mount Controller | 60-1284-02 |
| Optional Accessories | | |
| Model | Version Description | Part Number |
| XTP PI 100 | Single Port Power Injector | 60-1233-01 |
| PS 1210 C | 12V, 1A, Captivate Screw Connector | 70-775-01 |

For complete specifications, please go to www.extron.com
Specifications are subject to change without notice.

WORLDWIDE SALES OFFICES

Anaheim • Raleigh • Silicon Valley • Dallas • New York • Washington, DC • Toronto • Mexico City • Paris • London • Frankfurt
Stockholm • Amersfoort • Moscow • Dubai • Johannesburg • Tel Aviv • Sydney • Melbourne • New Delhi • Bangalore
Singapore • Seoul • Shanghai • Beijing • Hong Kong • Tokyo

www.extron.com