

DTP R HWP 4K 331 D

LONG DISTANCE DTP RECEIVER FOR
HDMI – DECORATOR-STYLE
WALLPLATE

DTP
SYSTEMS

4K UHD



The Extron DTP R HWP 4K 331 D is a single-gang decorator-style receiver that works with Extron DTP® 330-enabled products to send HDMI, analog audio, and bidirectional control signals up to 330 feet (100 meters) over a shielded CATx cable. It is designed for efficient use at display locations in environments offering limited space. The HDCP-compliant receiver features a convenient one-gang form factor that offers maximum placement flexibility.

- ▶ Receives HDMI plus control and analog audio up to 330 feet (100 meters) over a shielded CATx cable
- ▶ Supports computer and video resolutions up to 4K
- ▶ HDCP 2.2 compliant
- ▶ Supported HDMI specification features include data rates up to 10.2 Gbps, Deep Color up to 12-bit, 3D, HD lossless audio formats, and CEC pass-through
- ▶ Extron XTP DTP 24 shielded twisted pair cable is strongly recommended for optimal performance
- ▶ Supports EDID and HDCP transmission
- ▶ Bidirectional RS-232 and IR pass-through for AV device control
- ▶ Remote power capability
- ▶ Compatible with all DTP® 330 Series transmitters and DTP 330-enabled products
- ▶ Highly reliable, energy-efficient external universal power supply included with Tx models



Extron Electronics
INTERFACING, SWITCHING AND CONTROL

DESCRIPTION

The Extron **DTP R HWP 4K 331 D** is a single-gang, decorator-style, long distance receiver that works with Extron DTP 330-enabled products to send HDMI, audio, and bidirectional RS-232 and IR signals up to 330 feet (100 meters) over a shielded CATx cable. The one-gang form factor provides maximum space efficiency in wall mount, floor box, and furniture mount applications. The DTP R HWP 4K 331 D supports video signals at resolutions up to 4K. It also accepts analog stereo audio signals from a DTP 330-enabled product over the same shielded twisted pair cable. The wall-mountable design and remote power capability of the DTP R HWP 4K 331 D provide the convenience of placing output connections precisely where they are needed.

The DTP R HWP 4K 331 D enables the reliable transmission of HDMI signals, supporting Deep Color up to 12-bit, CEC pass-through, and embedded HD lossless audio formats. DDC communication of EDID and HDCP is continuously maintained between a source and display, ensuring direct compatibility and optimal signal transmission between devices. For added installation flexibility, the receiver can be remotely powered over the shielded twisted pair cable by a DTP 330-enabled product. The DTP R HWP 4K 331 D can be integrated with an Extron DTP CrossPoint® Presentation Matrix Switcher, or other DTP 330-enabled products to support sources at remote locations.

APPLICATION DIAGRAM

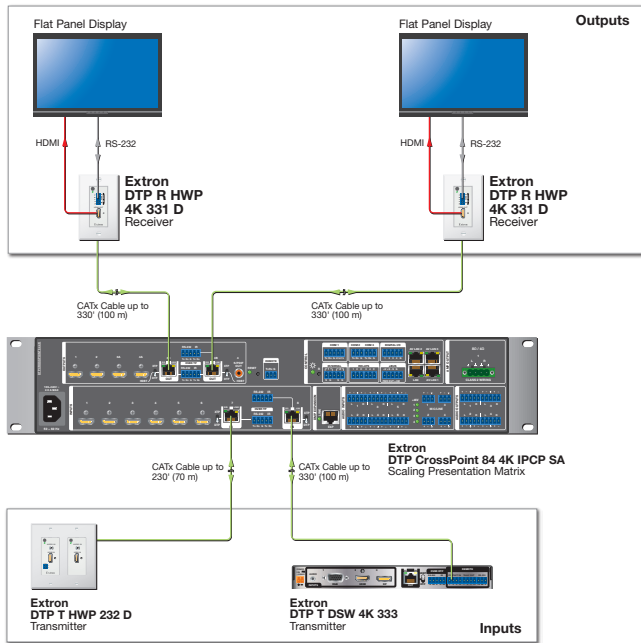

SPECIFICATIONS

TRUE 4K SPECIFICATION

Max. 4K Capabilities		
Resolution and Refresh Rate	Chroma Sampling	Max Bit Depth per Color
4096 x 2160 at 30 Hz 3840 x 2160 at 30 Hz	4:4:4	8 bit
4096 x 2160 at 60 Hz 3840 x 2160 at 60 Hz	4:2:0	8 bit
Frame rate ¹	24, 25, 30, 50, or 60 fps	
Chroma sampling ¹	4:4:4, 4:2:2, or 4:2:0	
Color bit depth ¹	8 bits per color	
Signal type	HDMI 1.4, HDCP 2.2	
Max. video data rate	10.2 Gbps (3.4 Gbps per color)	
NOTE: ¹ Subject to the maximum data rate limit. Use our calculator at www.extron.com/4Kdata to determine video parameters supported by this data rate.		

VIDEO

HDMI output

Maximum pixel clock	300 MHz
Resolution range	Up to 2560x1600* @ 60 Hz or 4K (4096x2160) @ 30 Hz, UHD (3840x2160) @ 30 Hz, 4K/UHD @ 60 Hz with 4:2:0 chroma subsampling (*Reduced blanking)

VIDEO OUTPUT

Connectors	1 female HDMI, type A
------------	-----------------------

INTERCONNECTION BETWEEN TRANSMITTER AND RECEIVER

Signal type	1 DTP 330 input
-------------	-----------------

DTP signal

Signal transmission distance	Up to 330' (100 m) using shielded twisted pair (STP) cable or XTP DTP 24 cable
1080p @ 60 Hz	Up to 330' (100 m) using STP cable or XTP DTP 24 cable
2560x1600 @ 60 Hz	Up to 330' (100 m) using STP cable or XTP DTP 24 cable
4K/UHD @ 30 and 60 Hz	Up to 330' (100 m) using STP cable or XTP DTP 24 cable
Cable requirements	Solid conductor, 24 AWG or better
Cable recommendations	400 MHz bandwidth STP cable
NOTE: Extron XTP DTP 24 shielded twisted pair cable is strongly recommended for optimal performance.	

AUDIO OUTPUT

Number/signal type	1 stereo, balanced/unbalanced
--------------------	-------------------------------

GENERAL

Power supply	External (not included) Input: 100-240 VAC, 50-60 Hz Output: 12 VDC, 1.5 A, 18 watts
--------------	--

Enclosure dimensions

Device	4.2" H x 1.7" W x 2.2" D (10.7 cm H x 4.3 cm W x 5.8 cm D)
--------	---

Regulatory compliance

	c-UL, C-tick, CE**, FCC Class A**, ICES, UL, VCCI Complies with the appropriate requirements of RoHS, WEEE
--	---

NOTE: **CE and FCC testing is conducted with STP cable.

NOTE: Shipping dimensions and weights are available at www.extron.com.

Model	Version Description	Part number
DTP R HWP 4K 331 D	HDMI Decorator-Style Rx, Black - 330 feet (100 m)	60-1531-52
DTP R HWP 4K 331 D	HDMI Decorator-Style Rx, White - 330 feet (100 m)	60-1551-53

For complete specifications, please go to www.extron.com
Specifications are subject to change without notice.

WORLDWIDE SALES OFFICES

Anaheim • Raleigh • Silicon Valley • Dallas • New York • Washington, DC • Toronto • Mexico City • Paris • London
Frankfurt • Madrid • Stockholm • Amersfoort • Moscow • Dubai • Johannesburg • Tel Aviv • Sydney • Melbourne
Bangalore • Mumbai • New Delhi • Singapore • Seoul • Shanghai • Beijing • Hong Kong • Tokyo

www.extron.com