

MLC 206 Backlight Replacement Guide

Replacement kits are available from Extron for the MLC's backlights. The MLC 206 is shown in the examples, but the instructions apply to all models. Follow the steps below to replace the backlight.

1. Remove the MLC from the furniture or wall (if it was previously installed) by removing the four screws marked ① in the picture below.
2. Use a small Philips screwdriver to remove the four faceplate attachment screws marked ② in the picture at right, and keep them for later use.

NOTE Do not remove these screws (②) while the MLC is installed in a wall or furniture, or the controller may fall down into the wall/furniture or wall box.

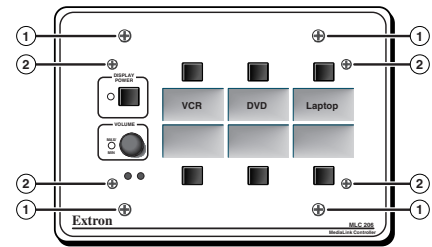

3. Lift the faceplate off the MLC.
4. Lift off the transparent, protective, plastic window that covers the labels.

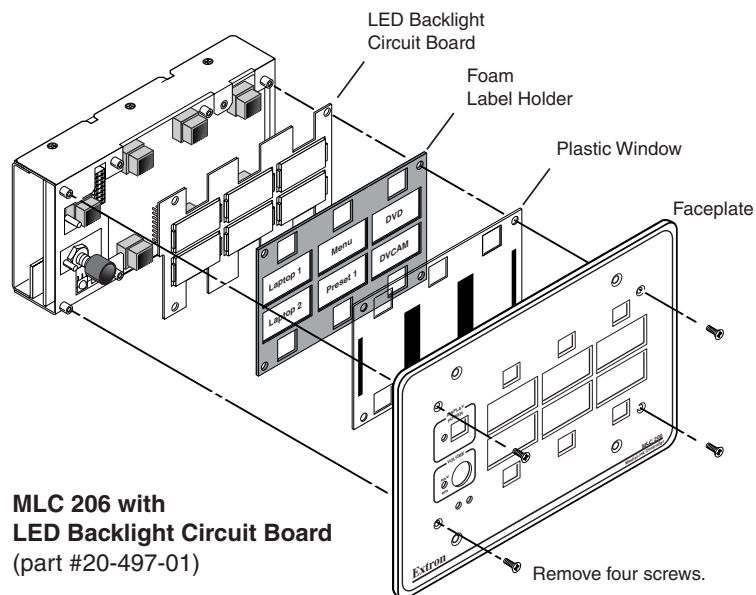
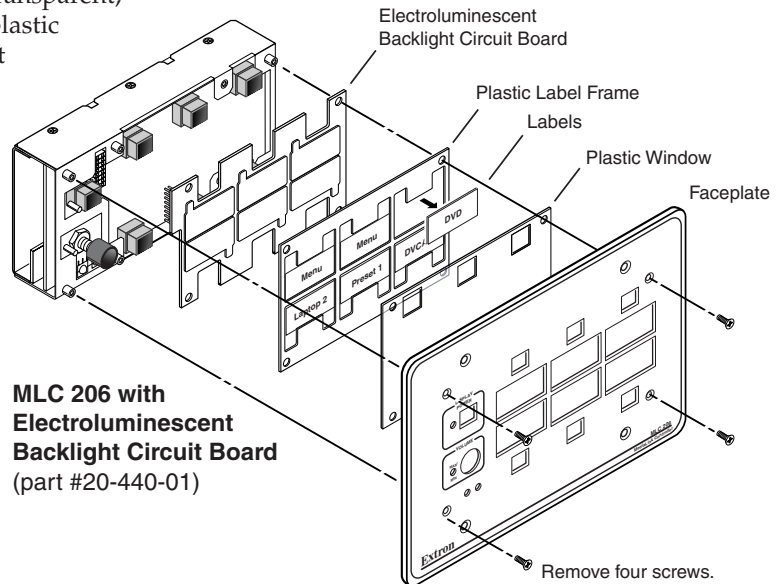

68-728-01 Rev. B
Printed in the USA
12 02

MLC 206 Backlight Replacement Guide, cont'd

5. Lift off the transparent, rectangular labels; save them for later use. You may need a small, flat bladed screwdriver to gently pry the labels out.

NOTE Note which labels were in which window so you can put them back in the same locations during reassembly.

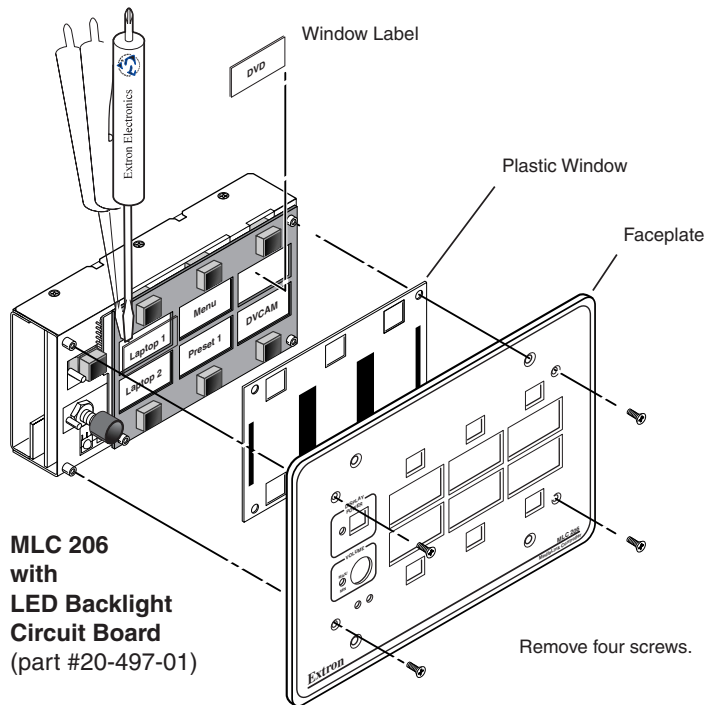
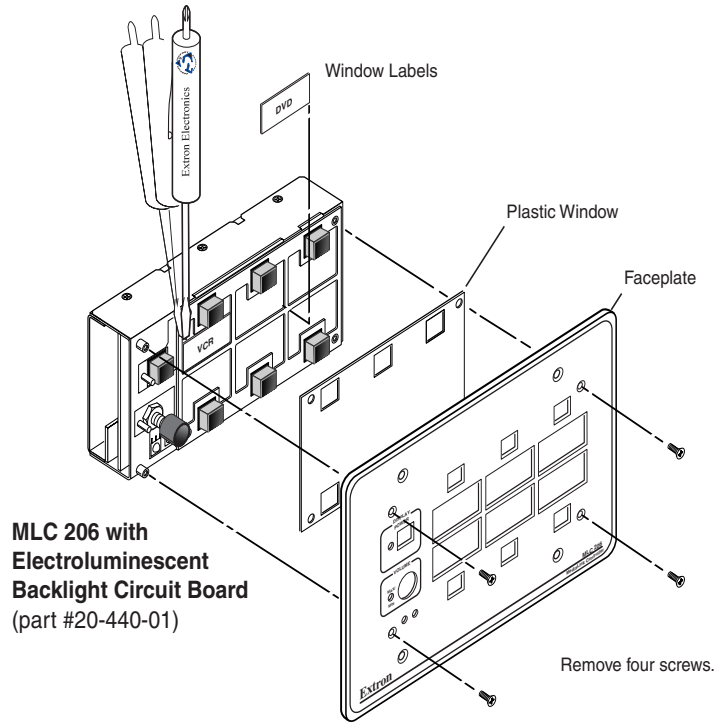

- Lift off the label-holding frame. For electroluminescent backlights, the frame is made of yellow, rigid plastic. For LED backlights, it is made of black, bendable foam.

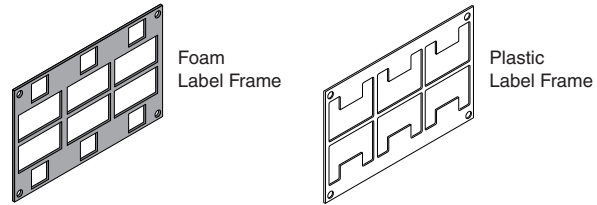

- Use a small, flat-bladed screwdriver or Extron tweeker to *gently* pry up the backlight circuit board. The connector that fastens the backlight circuit board to the main circuit board is in the upper left corner, near the Display Power button.

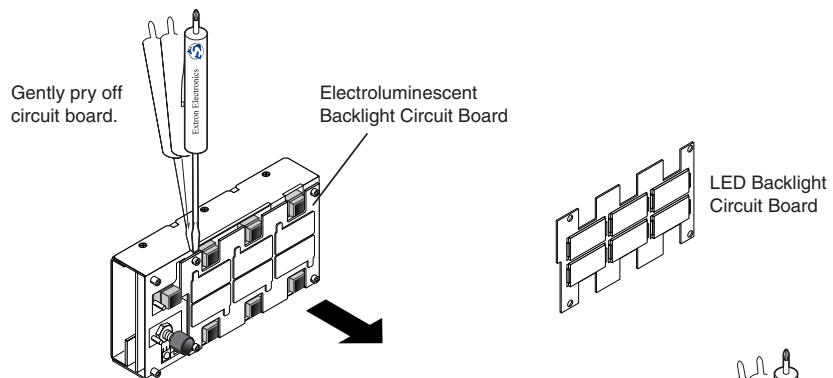

CAUTION

Because the LED-type backlight circuit board is much thinner than the board for the electroluminescent-type, it is easy to damage. Avoid bending or breaking the LED-type board.

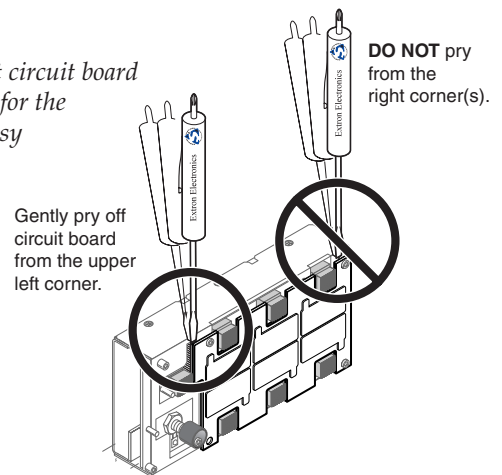
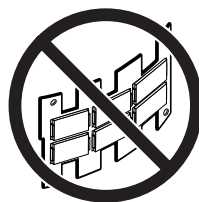

Lift the board straight off the MLC, and set it aside

- Orient the new backlight board in the same direction as the old board had been (as shown below), align the connectors, screw holes, and button holes, then *gently* and firmly press it into place.

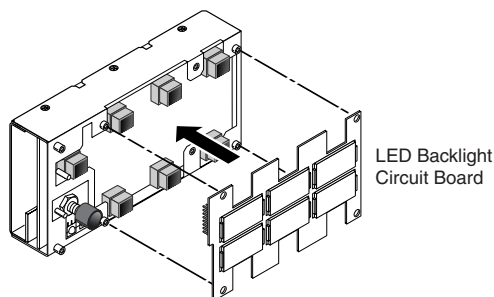

MLC 206 Backlight Replacement Guide, cont'd

9. Install the new label-holding frame from the replacement kit.
10. Insert the existing input window labels into the proper places in the frame (where noted in step 5), or install new window labels.
11. Peel off the protective film from the new clear plastic window (if applicable) and place the window onto the MLC to cover the labels.
12. Align the openings in the faceplate with the buttons, knobs, and LEDs of the MLC, and place the faceplate on the MLC.
13. Finally, insert the four screws removed in step 2, and hand tighten them. The MLC is now ready to be (re)installed in the wall or furniture.

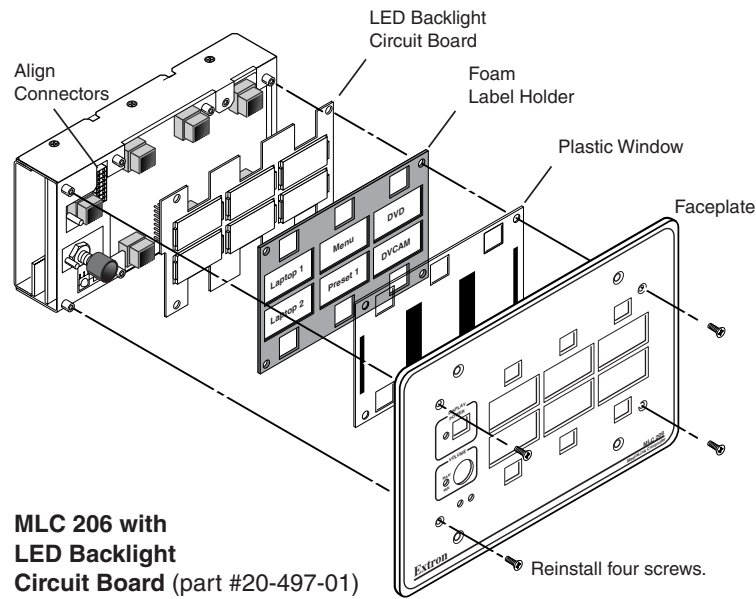

Included parts	Replacement part number
LED backlight kit (Board, #20-497-01; foam label holder, 100-162-01; clear plastic window, 100-140-02)	70-245-01



Extron Electronics, USA
 1230 South Lewis Street
 Anaheim, CA 92805
 USA
 714.491.1500
 Fax 714.491.1517

Extron Electronics, Europe
 Beeldschermweg 6C
 3821 AH Amersfoort
 The Netherlands
 +31.33.453.4040
 Fax +31.33.453.4050

Extron Electronics, Asia
 135 Joo Seng Road, #04-01
 PM Industrial Building
 Singapore 368363
 +65.6383.4400
 Fax +65.6383.4664

Extron Electronics, Japan
 Daisan DMJ Building 6F
 3-9-1 Kudan Minami
 Chiyoda-ku, Tokyo 102-0074 Japan
 +81.3.3511.7655
 Fax +81.3.3511.7656